

These drawings and specifications are the property of H2W Technologies, Inc. They are issued in confidence and shall not be reproduced, copied, or used without written permission from H2W Technologies, Inc. (www.h2wtech.com)

MOTOR HAS BEEN HIDDEN TO SHOW MOUNTING HOLES

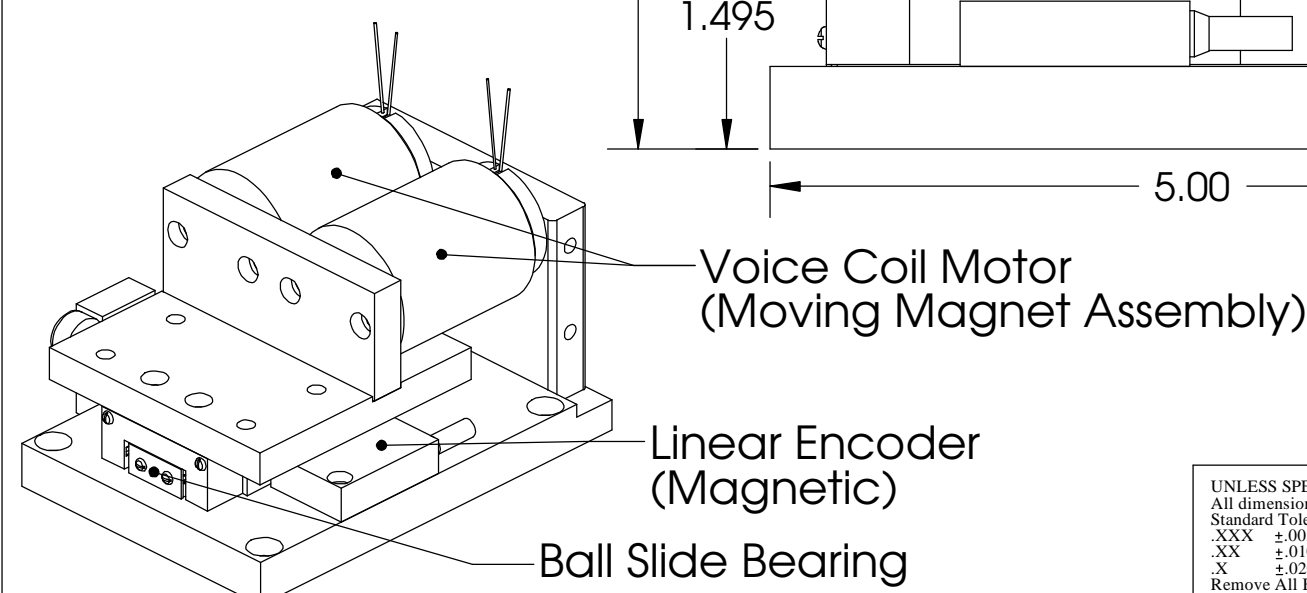
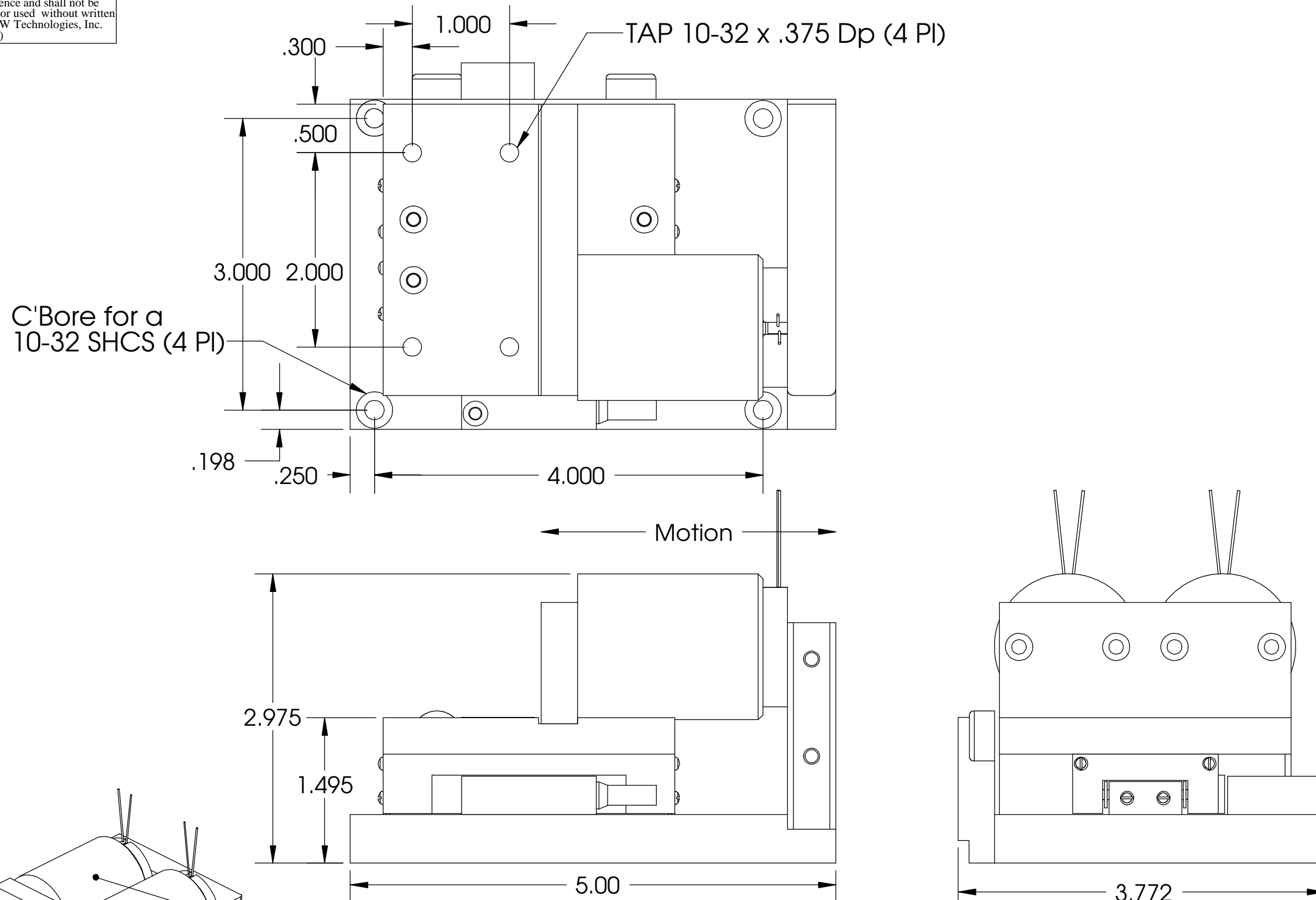

**H2W Technologies, Inc.**  
 26470 Ruether Ave #102 Santa Clarita, CA 91350 USA  
 Tel: (661) 251-2081 Fax: (661) 251-2067  
 www.h2wtech.com

**TITLE**  
 Voice Coil Positioning Stage  
 Model #VCS10-046-BS-01-M

UNLESS SPECIFIED OTHERWISE: All dimensions are in inches Standard Tolerances are as follows .XXX ±.005 ANGLES ±1° .XX ±.010 FILLETS .010 .X ±.020 CORNERS .010 Remove All Burrs and Sharp Edges				MATERIAL	
DRAWN OOG		DATE 12-5-07	APPROVED MPW	DATE 12-5-07	

DWG #	REV	SHEET
<b>31-0045</b>	<b>A</b>	1 of 2

<b>MOVING COIL NON-COMM ACTUATOR SPECIFICATIONS</b>		
Motor P/N	NCC10-15-023-1X	
Stroke	1.00"	25.4 mm
Encoder Resolution	1 micron	
Bearing Type	Ball Slide	
Moving Mass	.96 lbs	436 grams
Total Mass	2.32 lbs	1053 grams
Resistance @ 20C	15.0 ohms	
Inductance @ 20C	6.6 mH	
Electrical Time Constant	0.44 msec	
Motor Constant	1.70 LBS/SQRT(Watt)	7.5 N/SQRT(Watt)
Force Constant	4.6 LBS/Amp	20.4 N/Amp
Back EMF	0.52 V/ips	20.4 V/m/sec
Continuous Force	4.6 LBS	20.4 N
Max Power @ 100% Duty	14Watts	
Peak Force	13.8 LBS	61.4 N
Max Power @ 10% Duty	132 Watts	

NOTE: Electrical specs & masses are for two NCC10-15-023-1X motors

TITLE		
Voice Coil Positioning Stage <b>Model #VCS10-046-BS-01-M</b>		
DWG #	REV	SHEET
<b>31-0045</b>	<b>A</b>	2 of 2